

APPLICATION FOR GOVERNMENTAL AUTHORITY EXEMPTION
SECTION 367.022(2), FLORIDA STATUTES
RULE 25-30.060(3)(b), FLORIDA ADMINISTRATIVE CODE

947644-WS

ORIGINAL
FILE COPY

NAME OF SYSTEM: Riverwood

PHYSICAL ADDRESS OF SYSTEM: 4100 Riverwood Drive

Port Charlotte, Florida 33953

MAILING ADDRESS (IF DIFFERENT): 10300 NW 11 Manor, Coral Springs, FL 33071

COUNTY: Charlotte

PRIMARY CONTACT PERSON:

NAME: Gary . Moyer

ADDRESS: 10300 NW 11 Manor

Coral Springs, FL 33071

PHONE #: 305-753-0380

NATURE OF APPLICANT'S BUSINESS ORGANIZATION: (CORPORATION,
PARTNERSHIP, SOLE PROPRIETOR, ETC.) Municipal

I believe this system to be exempt from the regulation of the
Florida Public Service Commission pursuant to Section 367.022(2),
Florida Statutes, for the following reasons:

1. Statutory authority: Chapter 190 F.S.
2. The system is owned, operated, managed or controlled by
this governmental authority.
3. The following is a description of the nature of the
ownership, operation, management or type of control:
Fee simple total direct control on all phases of operation by C.D.D.
4. The utility services provided are:
Water yes (Yes or No) Wastewater yes (Yes or No)
For utility service not provided, state how handled:

DOCUMENT NUMBER-DATE

10418 OCT 23 82

FPSC-RECORDS/REPORTING

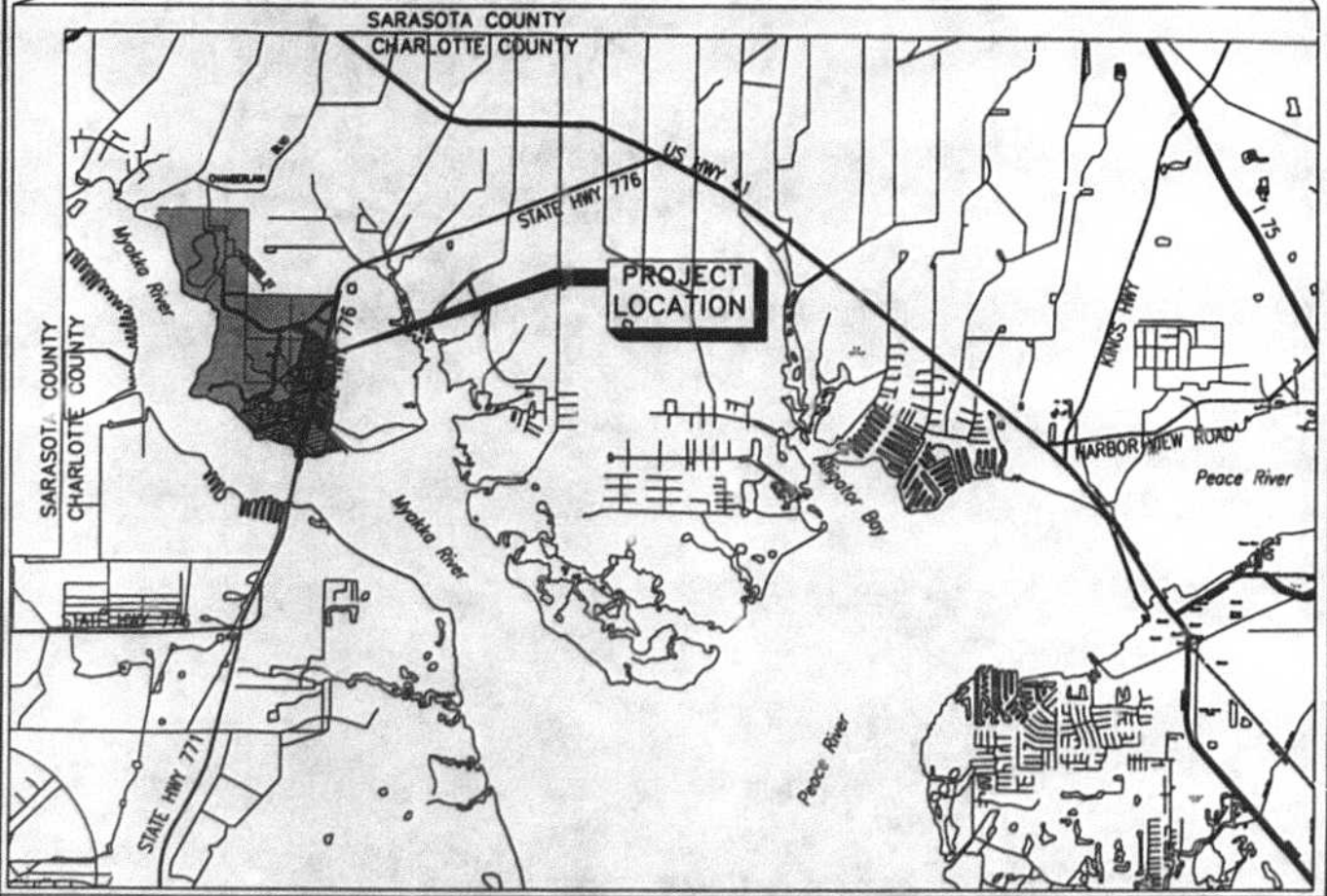
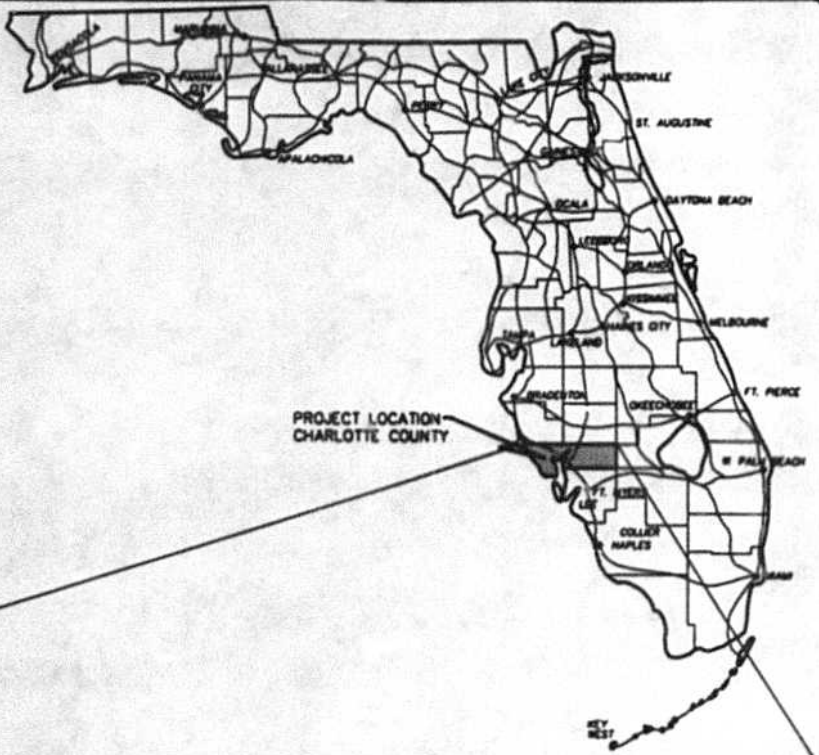



WILSON, MILLER, BARTON, & PECK, INC.
 ENGINEERS SURVEYORS PLANNERS ENVIRONMENTAL CONSULTANTS
 LANDSCAPE ARCHITECTS CONSTRUCTION MANAGERS
 4571 Colonial Blvd. Fort Myers, FL 33912 (813) 939-1020

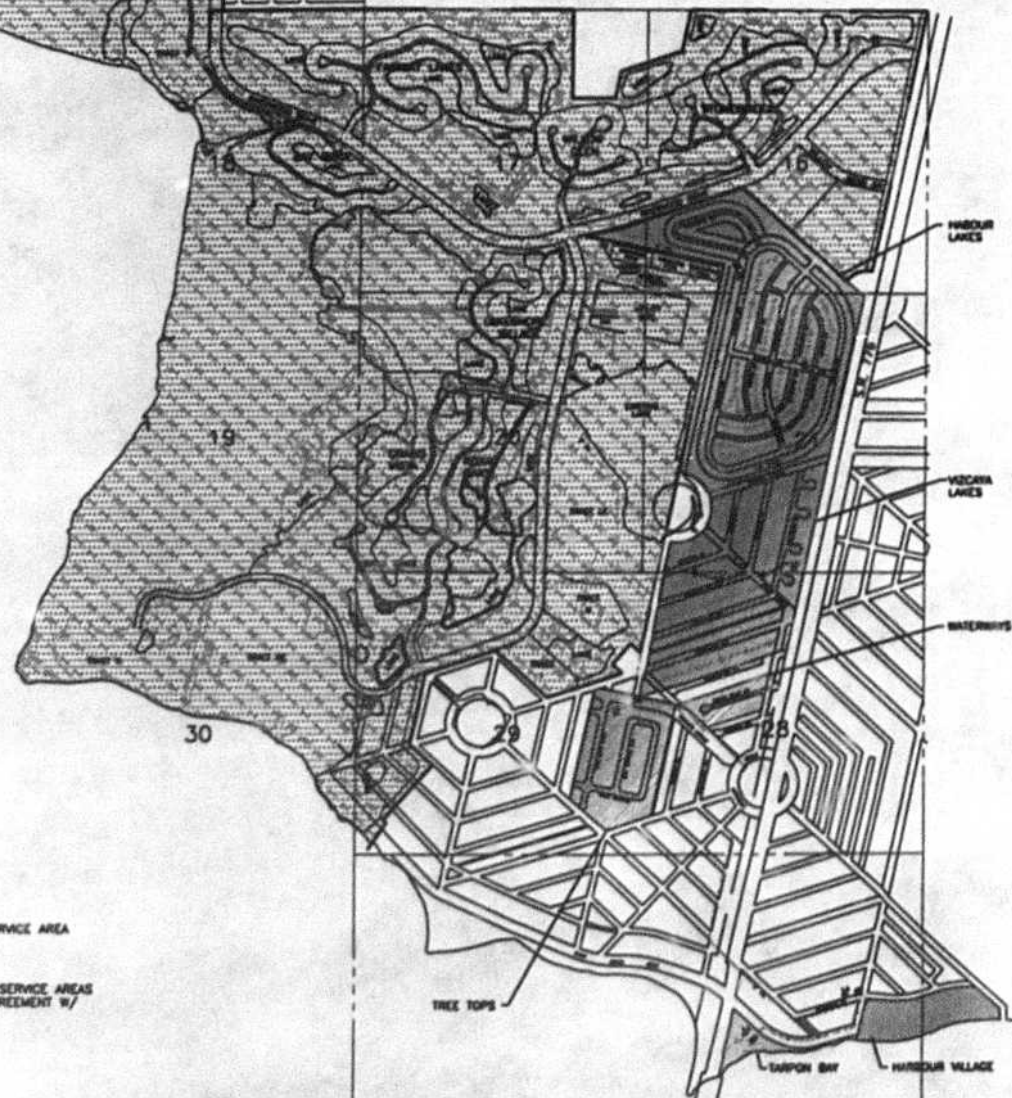
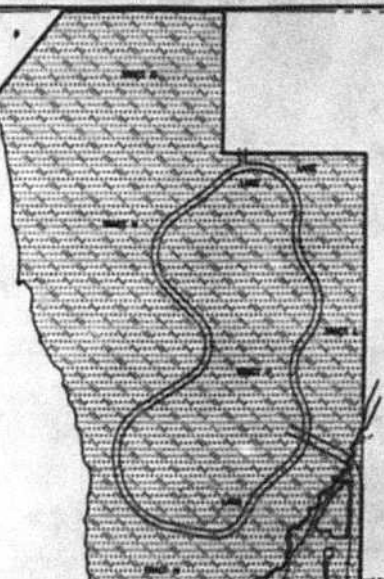
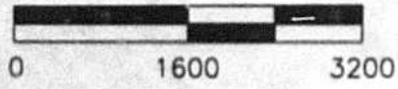

PROJECT:
RIVERWOOD COMMUNITY DEVELOPMENT DISTRICT
 4100 RIVERWOOD DR., PORT CHARLOTTE, FL 33653 (941) 255-1182
 Oct 16, 1995 - 10:37:55

TITLE:
SERVICE AREA LOCATION MAP
 0:\EML\0300\207\0300K701.dwg

DATE: OCT. 1995
 PROJECT NO. 20300
 SHEET NO.
1 of 1



LEGEND

-  - RIVERWOOD CDD SERVICE AREA
-  - OFFSITE CUSTOMER SERVICE AREAS PER INTERLOCAL AGREEMENT W/ CHARLOTTE COUNTY



WILSON, MILLER, BARTON, & PEEK, INC.
ENGINEERS SURVEYORS PLANNERS ENVIRONMENTAL CONSULTANTS
LANDSCAPE ARCHITECTS CONSTRUCTION MANAGERS
4571 Colonial Blvd. Fort Myers, FL 33912 (813) 939-1020

PROJECT:
RIVERWOOD COMMUNITY DEVELOPMENT DISTRICT
4100 RIVERWOOD DRIVE, PORT CHARLOTTE, FL 33851 (941) 233-1162

TITLE:
SANITARY SEWER SERVICE AREA MAP

DATE: OCT. 1995
PROJECT NO. 20.300

SHEET NO.
1 of 1

RIVERWOOD



Community Development District

October 18, 1995

ORIGINAL
FILE COPY

Director, Division of Records and Reporting
Florida Public Service Commission
2540 Shumard Oak Boulevard
Tallahassee, Florida 32399-0850

941044-WS
~~947044-WS~~

Gentlemen:

Enclosed please find one original and four copies of the Application for Government Authority Exemption for the Riverwood Water and Sewer System.

After your review of this application, if you have any questions or comments, please contact me.

Sincerely,

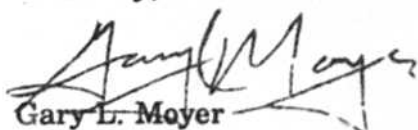
Gary L. Moyer
Manager

GLM/dh

enc.

ACK cc: Steve Clayton

- ATY _____
- AVI _____
- CAI _____
- CHS _____
- CLM _____
- COV _____
- CPH _____
- CSG _____
- CTG _____
- CVL _____
- DAW _____
- DEW _____
- DIA _____
- DIV _____
- DON _____
- DOR _____
- DRE _____
- DUN _____
- DUR _____
- DVA _____
- DWA _____
- DWS _____
- DWT _____
- DWY _____
- DZY _____
- OTH _____

MAIL ROOM

1995 OCT 23 AM 8 57

RECEIVED
FLORIDA PUBLIC
SERVICE COMMISSION

DOCUMENT NUMBER-DATE

10418 OCT 23 95

APPLICATION FOR GOVERNMENTAL AUTHORITY EXEMPTION
SECTION 367.022(2), FLORIDA STATUTES
RULE 25-30.060(3)(b), FLORIDA ADMINISTRATIVE CODE

9471044-WS
ORIGINAL
FILE COPY

NAME OF SYSTEM: Riverwood
PHYSICAL ADDRESS OF SYSTEM: 4100 Riverwood Drive
Port Charlotte, Florida 33953
MAILING ADDRESS (IF DIFFERENT): 10300 NW 11 Manor, Coral Springs, FL 33071

COUNTY: Charlotte

PRIMARY CONTACT PERSON:

NAME: Gary . Moyer
ADDRESS: 10300 NW 11 Manor
Coral Springs, FL 33071
PHONE #: 305-753-0380

NATURE OF APPLICANT'S BUSINESS ORGANIZATION: (CORPORATION, PARTNERSHIP, SOLE PROPRIETOR, ETC.) Municipal

I believe this system to be exempt from the regulation of the Florida Public Service Commission pursuant to Section 367.022(2), Florida Statutes, for the following reasons:

1. Statutory authority: Chapter 190 F.S.
2. The system is owned, operated, managed or controlled by this governmental authority.
3. The following is a description of the nature of the ownership, operation, management or type of control:
Fee simple total direct control on all phases of operation by C.D.D.
4. The utility services provided are:
Water yes (Yes or No) Wastewater yes (Yes or No)
For utility service not provided, state how handled:

APPLICATION FOR GOVERNMENTAL AUTHORITY EXEMPTION

5. The service territory is located at: _____

See attached map

I am aware that pursuant to Section 837.06, Florida Statutes, whoever knowingly makes a false statement in writing with the intent to mislead a public servant in the performance of his official duty shall be guilty of a misdemeanor of the second degree, punishable as provided in S. 775.082, S. 775.083, or S. 775.084.

10/19/95

(Date)

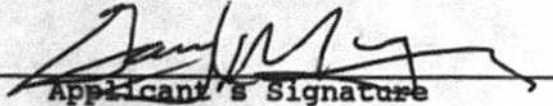

Applicant's Signature

Gary L. Moyer

Applicant's Name (Typed or Printed)

Manager

Applicant's Title

When you finish filling out this application, the original and four copies should be mailed to:

Director, Division of Records and Reporting
Florida Public Service Commission
2540 Shumard Oak Boulevard
Tallahassee, Florida 32399-0850

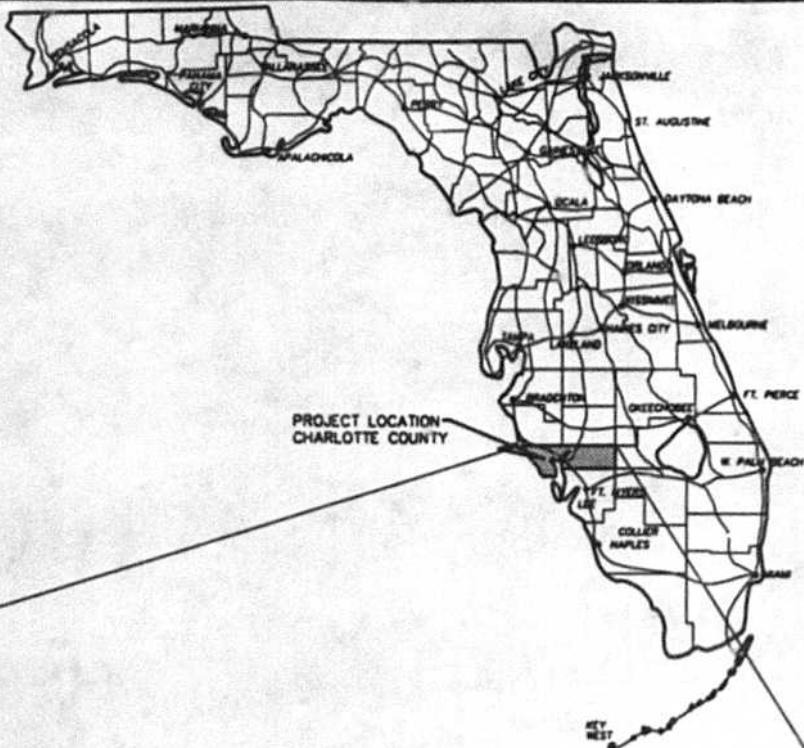

PROJECT LOCATION
CHARLOTTE COUNTY

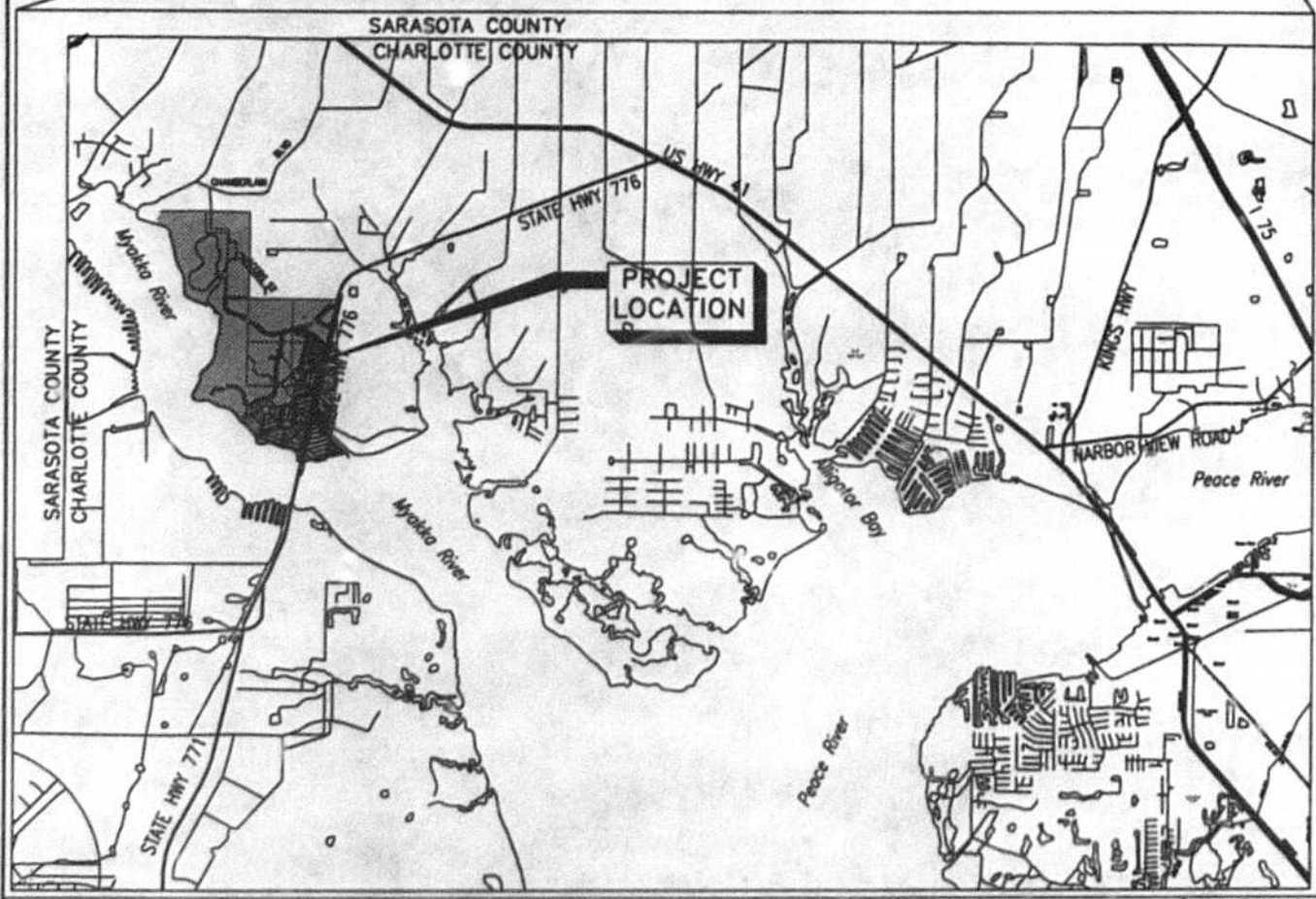

PROJECT
LOCATION

WILSON, MILLER, BARTON, & PEEK, INC.
 ENGINEERS SURVEYORS PLANNERS ENVIRONMENTAL CONSULTANTS
 LANDSCAPE ARCHITECTS CONSTRUCTION MANAGERS
 4571 Colonial Blvd. Fort Myers, FL 33912 (813) 939-1020



PROJECT:
RIVERWOOD COMMUNITY DEVELOPMENT DISTRICT
 4100 RIVERWOOD DRIVE, PORT CHARLOTTE, FL 33853 (941) 255-1182
 Oct 16, 1995 - 10:37:55

FILE:
**SERVICE AREA
 LOCATION MAP**
 D:\EML\0300\207\0300K701.dwg

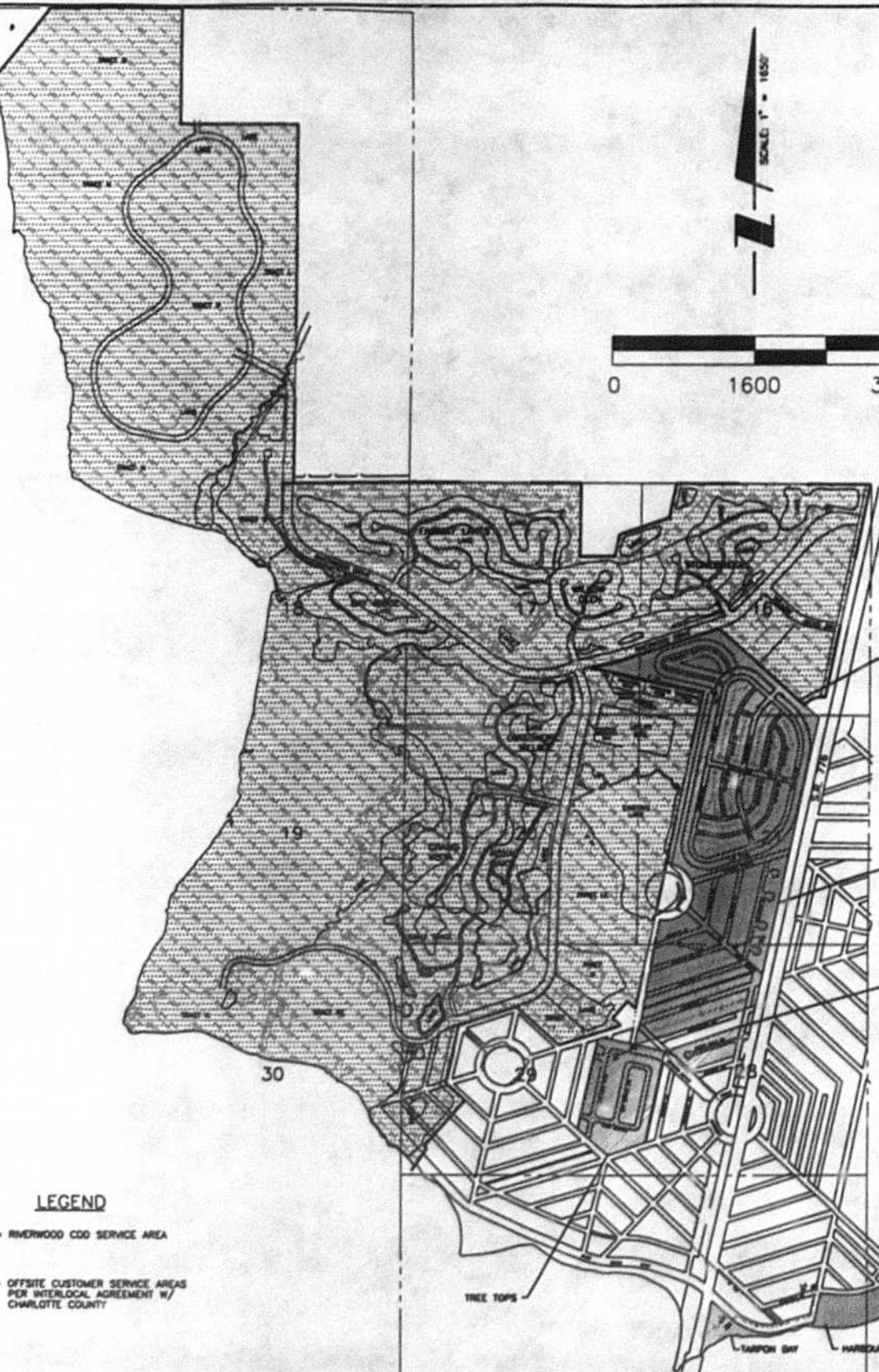
DATE: OCT. 1995
 PROJECT NO. 20.300
 SHEET NO.
1 of 1



LEGEND

-  - RIVERWOOD CDD SERVICE AREA
-  - OFFSITE CUSTOMER SERVICE AREAS PER INTERLOCAL AGREEMENT W/ CHARLOTTE COUNTY

WILSON, MILLER, BARTON, & PEEK, INC.
 ENGINEERS SURVEYORS PLANNERS ENVIRONMENTAL CONSULTANTS
 LANDSCAPE ARCHITECTS CONSTRUCTION MANAGERS
 4571 Colonial Blvd. Fort Myers, FL 33912 (813) 939-1020

PROJECT:
RIVERWOOD COMMUNITY DEVELOPMENT DISTRICT
 4100 RIVERWOOD DRIVE, FORT CHARLOTTE, FL 33851 (941) 255-1142

TITLE:
SANITARY SEWER SERVICE AREA MAP

DATE: OCT. 1995
 PROJECT NO. 20,300
 SHEET NO.

1 of 1

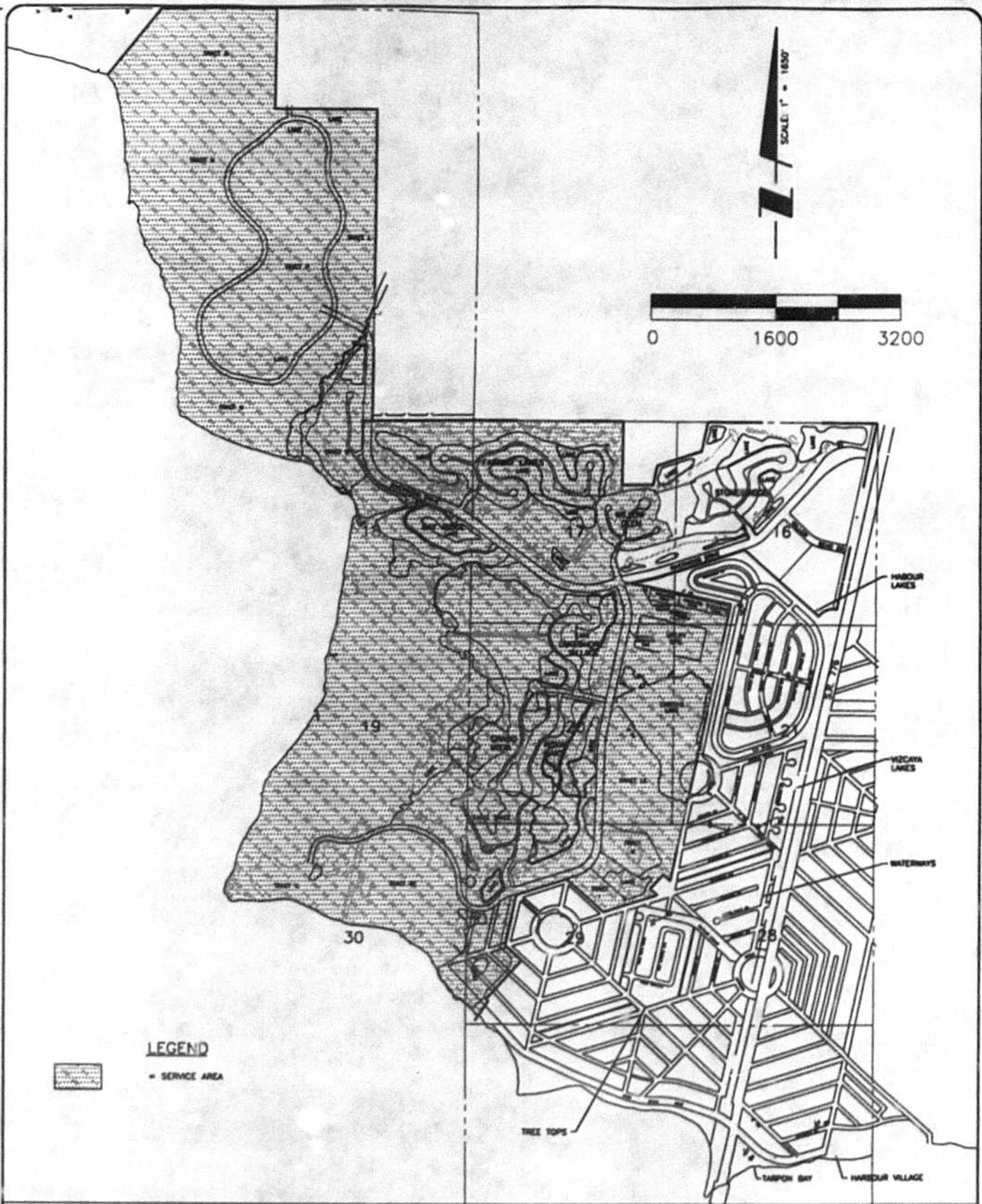

LEGEND

 = SERVICE AREA

WILSON, MILLER, BARTON, & PEEK, INC.
 ENGINEERS SURVEYORS PLANNERS ENVIRONMENTAL CONSULTANTS
 LANDSCAPE ARCHITECTS CONSTRUCTION MANAGERS
 4571 Colonial Blvd. Fort Myers, FL 33912 (813) 939-1020

PROJECT:
RIVERWOOD COMMUNITY DEVELOPMENT DISTRICT
 4100 RIVERWOOD DR., FORT CHARLIE, FL 33655 (941) 255-1162

TITLE:
POTABLE WATER SERVICE AREA MAP
Oct 14, 1995 - 08:48:01 - 813/2122207/20300/1.dwg

DATE: OCT. 1995
 PROJECT NO. 20300
 SHEET NO.
1 of 1