

AUSLEY & MCMULLEN

ATTORNEYS AND COUNSELORS AT LAW

227 SOUTH CALHOUN STREET
P.O. BOX 391 (ZIP 32302)
TALLAHASSEE, FLORIDA 32301
(850) 224-9115 FAX (850) 222-7560

080141

March 7, 2008

HAND DELIVERED

RECEIVED-FPSC
08 MAR -7 AM 11:14
COMMISSION
CLERK

Ms. Ann Cole, Director
Division of Commission Clerk
Florida Public Service Commission
2540 Shumard Oak Boulevard
Tallahassee, Florida 32399-0850

Re: Joint Petition of Tampa Electric Company and Withlacoochee River Electric Cooperative, Inc. for Permanent Relocation of Territorial Boundaries

Dear Ms. Cole:

Enclosed for filing in the above-styled matter are the original and fifteen (15) copies of a Joint Petition of Tampa Electric Company and Withlacoochee River Electric Cooperative, Inc. for Approval of Limited Amendments to Territorial Boundaries.

Please acknowledge receipt and filing of the above by stamping the duplicate copy of this letter and returning same to this writer.

Thank you for your assistance in connection with this matter.

Sincerely,

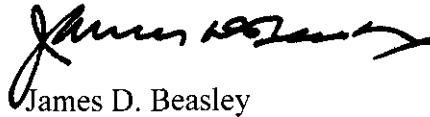

James D. Beasley

CMP _____

COM _____

CTR _____ JDB/pp

ECR _____ Enclosure

GCL 2 cc: All parties of record (w/enc.)

OPC _____

RCA _____

SCR _____

SGA _____

SEC _____

CLK 1

OTH _____

DOCUMENT NUMBER-DATE

01726 MAR-7 08

FPSC-COMMISSION CLERK

BEFORE THE FLORIDA PUBLIC SERVICE COMMISSION

In re: Joint Petition of Tampa Electric Company)
And Withlacoochee River Electric Cooperative,)
Inc. for Permanent Relocation of)
Territorial Boundaries)
_____)

DOCKET NO. 080141

FILED: March 7, 2008

**JOINT PETITION OF TAMPA ELECTRIC COMPANY AND
WITHLACOOCHEE RIVER ELECTRIC COOPERATIVE, INC. FOR
APPROVAL OF LIMITED AMENDMENTS TO TERRITORIAL BOUNDARIES**

Tampa Electric Company ("Tampa Electric" or "the company") and Withlacoochee River Electric Cooperative, Inc. ("WREC"), jointly petition the Florida Public Service Commission ("Commission") to approve certain proposed changes in the Joint Petitioners' existing Commission approved service territory boundary, as described in more detail below and in the Exhibits attached hereto. In support thereof, the Joint Petitioners say:

1. Tampa Electric is a Commission regulated electric utility within the meaning of Section 366.02, Florida Statutes, whose principal place of business is located in Tampa, Florida. WREC is a rural electric cooperative organized and existing under Chapter 425, Florida Statutes, and under the Rural Electrification Act, 7 USC, Section 901, et. seq., with a principal place of business in Dade City, Florida.

2. The name, address and telephone numbers of the Joint Petitioners are as follows:

Tampa Electric Company	Withlacoochee River Electric Cooperative, Inc.
Post Office Box 111	Post Office Box 278
Tampa, FL 33601	Dade City, FL 33526-0278
(813) 228-4111	(352) 567-5133

3. All notices and pleadings in this matter should be served upon the following:

DOCUMENT NUMBER-DATE

01726 MAR-7 8

FPSC-COMMISSION CLERK

For Tampa Electric:

Paula K. Brown
Administrator - Regulatory Coordination
Tampa Electric Company
Post Office Box 111
Tampa, FL 33601
(813) 228-1444

Lee L. Willis
James D. Beasley
Ausley & McMullen
Post Office Box 391
Tallahassee, FL 32302
(850) 224-9115

For WREC:

Billy E. Brown
Withlacoochee River Electric
Cooperative, Inc.
Post Office Box 278
Dade City, FL 33526-0278

4. Tampa Electric and WREC are parties to a territorial agreement that was approved by this Commission in Order No. 23905 issued in Docket No. 900752-EU on December 20, 1990. On June 10, 2002 the Commission entered Order No. PSC-02-0790-PAA-EU in Docket No. 020147-EU approving customer transfers to conform to the territorial boundaries between Tampa Electric and WREC. The provisions of that order became final and effective upon the Commission's issuance of its consummating order on July 10, 2002, Order No. PSC-02-0926-CO-EU. The territorial boundary between Tampa Electric and WREC was further amended on February 16, 2006 with the Commission's issuance of Order No. PSC-06-0128-PAA-EU in Docket No. 041408-EU. That proposed agency action became final with the issuance of Order No. PSC-06-0200-CO-EU, dated March 13, 2006.

5. The Petitioners have been asked to provide service to portions of the Meadow Point subdivision ("Meadow Point") now under construction in Pasco County, Florida. Specifically, Meadow Point is located one mile north of the Pasco-Hillsborough County line, 3.5 miles east of Bruce B. Downs Blvd. The currently approved service territory boundary between the Petitioner's respective service territories transects Meadow Point in a manner that does not

follow the topography and street grids in a logical manner. As a result, service to the portion of Meadow Point located within their existing service area by each Petitioner would be inefficient and not in the best interest of electric customers in Meadow Point.

6. The Joint Petitioners ask that the Commission modify their existing service territory boundary in Meadow Point so that groups of lots currently transected by the existing boundary line can be served entirely by one Petitioner or the other.

7. Exhibit A to this petition shows the lots at issue and the existing service territory boundary line (Segment A – B). The Petitioners request that the boundary line be modified as illustrated in Exhibit B to this petition. In Exhibit B, Tampa Electric's new service territory would cover the area highlighted with red cross hatching and WREC's new service area would be represented by the un-highlighted area of the map. The proposed service territory boundary follows lot lines and will make it much more cost-effective for WREC and Tampa Electric to serve the customers in question.

8. Except as explicitly described above, the joint petitioners request that the existing service territory boundary remain unchanged. Subject to its approval by the Commission, this joint petition is also intended by Tampa Electric and WREC to serve as and constitutes an amendment to the June 12, 1990 territorial agreement which the Commission approved in Order No. 23905, issued in Docket No. 900752-EU on December 20, 1990. Tampa Electric and WREC agree that each and every provision of that 1990 agreement should remain in full force in effect, except to the extent modified herein and by earlier amendments approved by the Commission. Joint Petitioners urge the Commission to so rule in its disposition of this joint petition.

9. Tampa Electric and WREC are not aware of any disputed issues of material fact relative to the matters addressed in this joint petition.

10. The undersigned has conferred with representatives of WREC and is authorized to file this Joint Petition on behalf of both Tampa Electric and WREC.

WHEREFORE, Tampa Electric and WREC petition the Commission to approve the above-described permanent service territory boundary changes and to approve this joint petition as an amendment to the territorial agreement approved by the Commission in Order No. 23905 issued in Docket No. 900752-EU on December 20, 1990.

DATED this 7th day of March 2008.

Respectfully submitted,

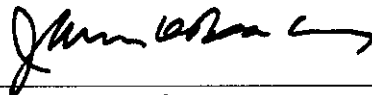

LEE L. WILLIS
JAMES D. BEASLEY
Ausley & McMullen
Post Office Box 391
Tallahassee, FL 32302
(850) 224-9115

ATTORNEYS FOR TAMPA
ELECTRIC COMPANY

CERTIFICATE OF SERVICE

I HEREBY CERTIFY that a true copy of the foregoing Joint Petition has been served by hand delivery (*) or U. S. Mail on this 7th day of March 2008 to the following:

Office of General Counsel
Florida Public Service Commission
2540 Shumard Oak Boulevard
Tallahassee, FL 32399-0850

Billy E. Brown
Executive V. P. and General Manager
Withlacoochee River Electric
Cooperative, Inc.
Post Office Box 278
Dade City, FL 33526-0278



ATTORNEY

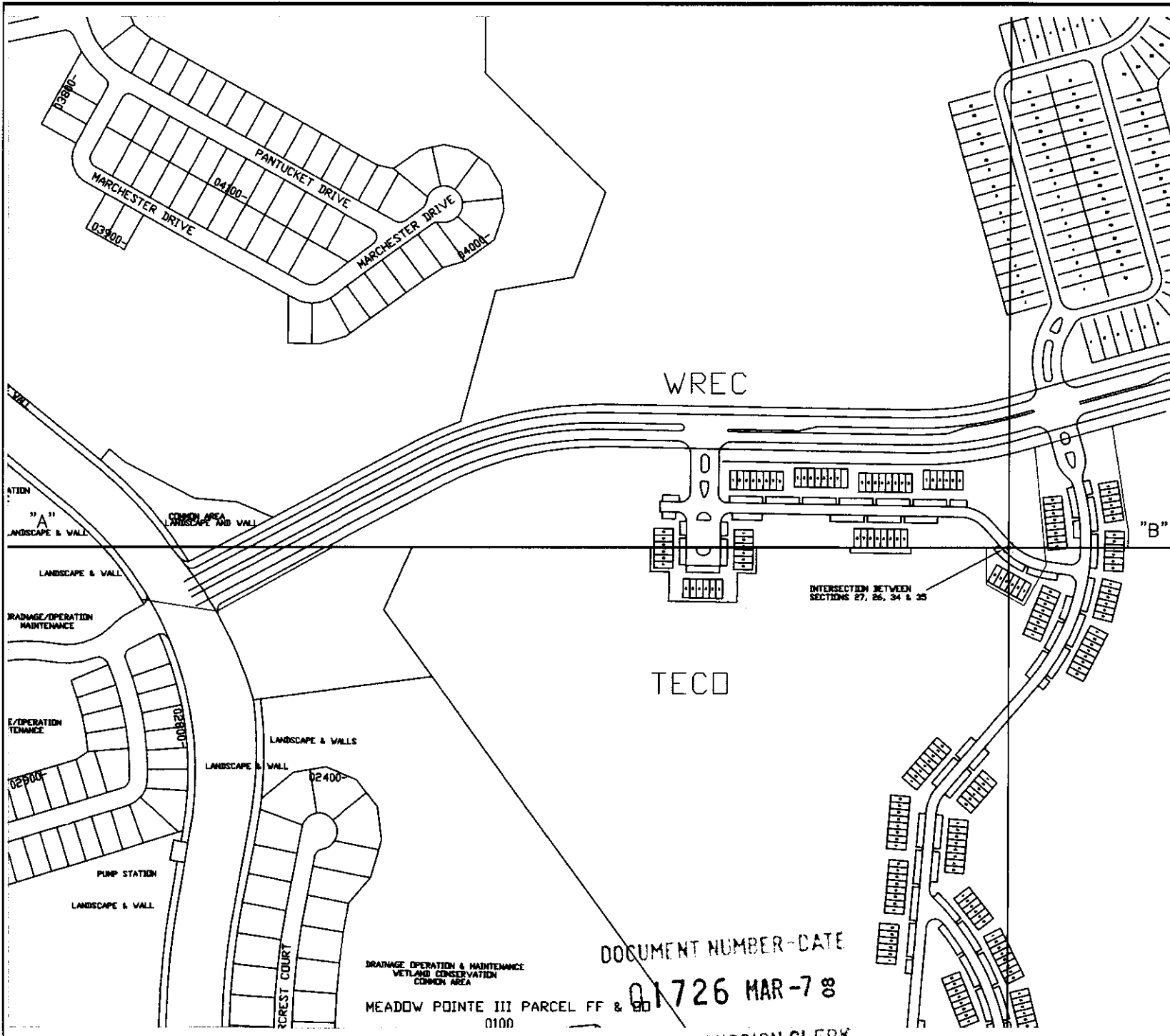

EXHIBIT "A"

JUNE 2007 PROPOSED TERRITORIAL BOUNDARY LINE FOR MEADOW POINTE AA SOUTH SUBDIVISION

EXHIBIT "B"

JUNE 2007 PROPOSED TERRITORIAL BOUNDARY LINE FOR MEADOW POINTE AA SOUTH SUBDIVISION

REVISION - FEBRUARY 4, 2008

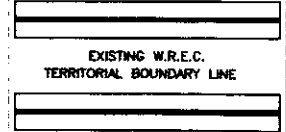

SCALE 1:200

DOCUMENT NUMBER-DATE

01726 MAR-7 08

DRAINAGE OPERATION & MAINTENANCE
WETLAND CONSERVATION
COMMON AREA
MEADOW POINTE III PARCEL FF & GD
0100

FPSC-COMMISSION CLERK